

Hybrid control panels

There are 2 control panels in the PCX hybrid range:

- PCX 78S approved to EN50131 Grade 2
- PCX 78L approved to EN50131 Grade 3

The panels are suitable for residential and small to medium commercial installations.

Up to 78 wired & wireless peripherals

Using the wired and wireless input expanders the PCX panels can support up to 78 inputs. This provides the installer the flexibility to add additional indoor and outdoor sensors to the system.

High security Enforcer two-way wireless

The wireless expander (PCX RIX32-WE) uses the highly secure Enforcer two-way wireless protocol, which supports up to 32 wireless devices, 32 keyfobs, 4 arming stations and 2 wireless sirens. This means that installers can seamlessly add wireless indoor and outdoor detectors, shock sensors and safety sensors to the system.

Up to 78 wired inputs with triple EOL wiring capability

The wired input expanders support inertia and roller shutter sensors, as well as high-end anti-masking detectors, via the triple EOL wiring capability.

Common housing for a unified look

The common housing throughout our wired and two-way wireless peripherals ensure aesthetic consistency, should the installer decide to create a hybrid system.

Communications, diagnostics & App compatibility

Using IP modems such as the DIGI-LAN, DIGI-WIFI/XA or DIGI-GPRS, the PCX range is fully compatible with the PyronixCloud, Hik-Connect or ProControl+ App, ENIP server and UDL InSite software. This enables controls, Alarm Receiving Centre (ARC) connections and remote diagnostics of the system.

The PCX control panels also support the DIGI-PSTN modem, which can be used as a second path communicator.

Automation outputs

The PCX range supports up to 30 wired automation outputs to give the user control of garage doors, gates or shutters for example. These can be controlled via the Hik-Connect or ProControl+ App, keyfob or wired and wireless keypad.

PCX App hybrid system architecture

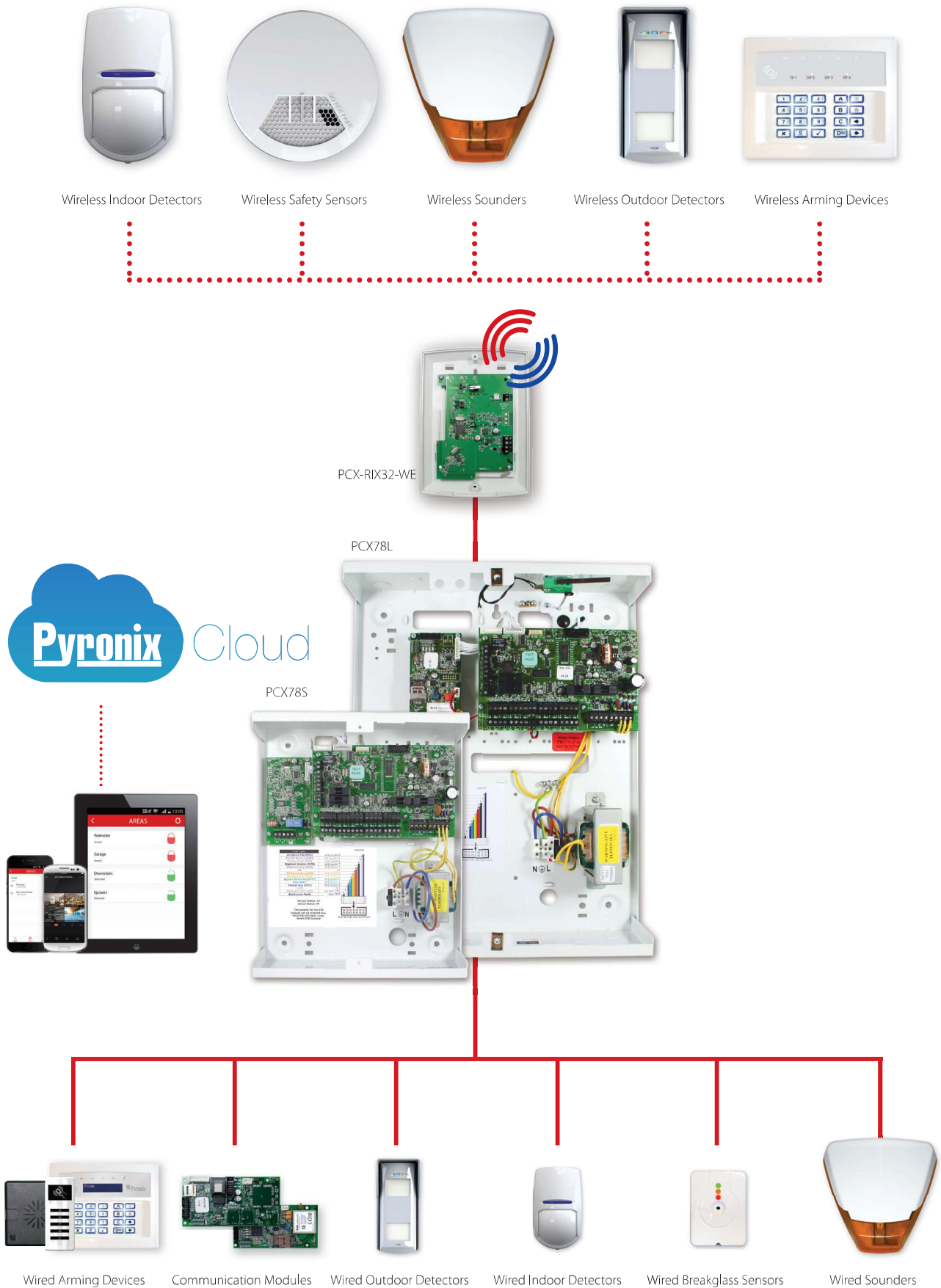

PCX hybrid control panels



PCX 78S**



PCX 78L**

Partcode

What's in the box

Tamper protected housing	✓ (Metal)	✓ (Metal)
PCB	✓	✓
Power supply on board	✓	✓
Keypad	✗	✗
Communications module	✗	✗

Key features

Areas (independent or level)	8	8
Maximum inputs	78	78
- Onboard	10 wired	10 wired
Maximum outputs	85	85
- Onboard	5	5
Set / unset methods	App pin, prox or keyfob	App pin, prox or keyfob
User codes	100	100
- Guard / duress	10	10
System logs	1250	1250
Programmable automation types	30	30

Wireless devices

Maximum inputs (requires RIX32-WE)	64	64
- Onboard	-	-
Keyfobs	32	32
Arming stations	4	4
Sounders	2	2

Wired devices

Maximum inputs	78	78
- Onboard	10	10
Maximum outputs	85	85
- Onboard	6	6
Maximum keypads	6	6
Maximum readers	5	5

Communication

Module compatibility	DIGI-WIFI, DIGI-LAN, DIGI-GPRS+SIM, DIGI-GPRS, DIGI-GSM, DIGI-PSTN	DIGI-WIFI, DIGI-LAN, DIGI-GPRS+SIM, DIGI-GPRS, DIGI-GSM, DIGI-PSTN
App compatibility	✓	✓
Push notifications	✓	✓
Signalling protocols	Contact ID IP, Contact ID, SIA IP, SIA3, Fast Format IP, Fast Format and SMS	Contact ID IP, Contact ID, SIA IP, SIA3, Fast Format IP, Fast Format and SMS

Technical specification

Power supply on board	✓	✓
- Quiescent output voltage	~21.0VDC	~21.0VDC
- Maximum rating	1.5A	2.0A
Panel current consumption	80mA	80mA
Battery capacity	2 - 7Ah	7 - 17Ah
AUX output voltage	~13.7VDC	~13.7VDC
Input resistors	1k tamper / 1k alarm	1k tamper / 1k alarm

Other details

Operating temperature	-10°C to +40°C	-10°C to +40°C
Dimensions (W x H x D)	297 x 250 x 82mm	305 x 390 x 100mm
Weight	4.8kg inc. battery	11.5kg inc. battery
Warranty (years)	2	2

Certifications

Electrical conformity	CE	CE
EN50131	Security Grade 2	Security Grade 3
Environmental classification	II	II
SAP Code	361300112	361300023

*Smartphone not included
**Version 12 specifications